

Standard equipment

- MAPLAN FIFO rubber injection unit with short, cooled nozzle for high precision and injection capacity, easy cleaning
- Large heating platen and daylight for more cavities and easy demoulding
- Control PC5000touch
- High resolution ultrasonic linear encoder system for best reproducibility
- Hydraulic pump with proportional pressure / flow control
- 2-circuit-cooling unit (thermo oil) for plasticizing cylinder and injection pot
- Machine covers with integrated light shield for highest safety and ergonomics
- Maintenance-free, contactless safety switches
- Solid state relays for heating zones
- Oil filter, oil level- and oil temperature control
- Electric backpressure adjustment

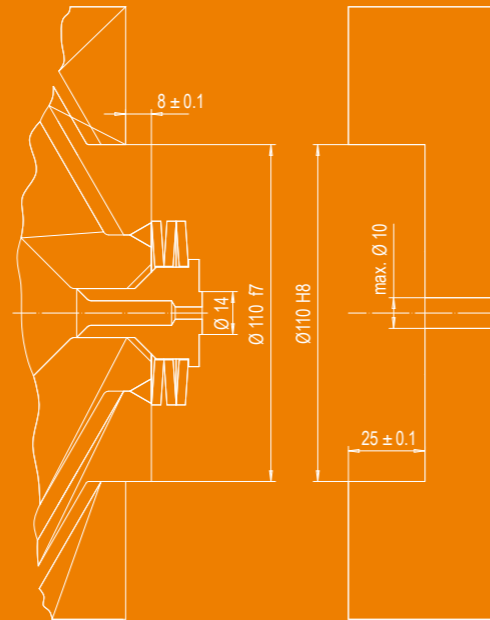

Mould centering diagram

Options

- Hydraulic ejector injection and/or clamp side, linear positioning system
- Heating and cooling devices for plasticizing cylinder, injection pot, screw or cold runners
- Vacuum pump
- Additional features for PC5000touch
- Alternative injection volumes
- Additional mould heating zones
- Strip intake control
- Automatic strip intake device
- Hydraulic sliding plates 70%
- Shuttle front- or rear side
- Double shuttle and fast double shuttle system
- Heating plates change
- 3-zone heating plates control
- Stockfeeder for silicone processing
- Euromap67 interface
- Logical Movements
- Oil cooling
- Energy saving MAPLAN CoolDrive - system

other options on request

Machine type		MTF 1500/280eg	MTF 1500/460eg	MTF 2500/630eg
Clamp unit				
Opening stroke	mm	599	600	910
Opening between plates	mm	799	850	1110
Clamping force	kN	2835	4524	6160
Min. mould height	mm	200	250	200
Max. mould height	Mm	557	520	680
Heating plates, standard	mm	560 x 650	710 x 800	810 x 1000
Injection unit				
Max. injection volume standard	cm ³	1500	1500	2500
Optional injection volumes	cm ³	2000/2500/3200	2000/2500/3200	2000/4000
	cm ³		4000/5300/6000/8000	4000/5300/6000/8000
	cm ³	2500eg	4000eg/6000eg	4000eg/6000eg
Machine weight	kg	7500	13000	22000
Floor space required	m ²	3,9	6,1	6,3

© MAPLAN 09/2010 | We reserve the right to technical modifications.



rubber injection technology

MAPLAN ergonomic

RUBBER INJECTION MOULDING MACHINES
WITH OPTIMAL ERGONOMIC WORKING HEIGHT FOR
FULL AUTOMATIC PRODUCTION OF HIGH SOPHISTI-
CATED TECHNICAL RUBBER AND SILICONE PARTS





MTF 4000eg/400eg

MAPLAN ergonomic
Machines for production of high sophisticated technical rubber, silicone, rubber metal and 2-component parts.



Product range
Production of moulded parts from rubber, silicone, rubber metal and multi component up to 8000 cm³



The one and only parallel plane
Optimum mould clamping by eliminating deflection of the fixed plate injection side, maximum platen support by the massive clamp cylinder



Ergonomic working height
no pedestals needed



Full Automation
Movement of mould plates to front and rear including demoulding devices, brushing devices and robots for loading and unloading

The MAPLAN FIFO Rubber injection unit

- FIFO injection unit concept
- Short nozzle for max. injection pressure directly on the mould
- Ergonomic strip intake height
- Cooled nozzle - no nozzle retract necessary and therefore no leaks
- Easy material change and cleaning via moveable check valve
- Adjustable back pressure function
- Oil temperature control for plasticizing unit, injection pot and nozzle
- Constant screw length to diameter ratio

